



WINGS *and* RINGS

PROJECT: BW & R Campbellsville, KY

ADDENDUM NO: 002 - clouded 1 on plans

ISSUE DATE: 12-22-2020

Drawings Affected: G001 Cover Sheet

Comments:

Updated responsibility matrix

Permit Status: _____

If you have any questions, please let us know.

Beth Sizemore
BWR Corporate
513.638.0036
esizemore@buffalo-wing.com

Lacie DeJournett
Intertech Design Services
Phone:(513) 791-5588
Direct: (513) 864-6822
LDejournett@IntertechDesign.NET

PROJECT RESPONSIBILITY MATRIX

NOTE: GENERAL CONTRACTOR TO ASSUME ALL ITEMS NOT INDICATED ON RESPONSIBILITY MATRIX SHALL BE FURNISH, INSTALLED AND COORDINATED BY GENERAL CONTRACTOR.

NO.	DESCRIPTION	OWNER	DESIGNER	GC	EXC.	NOTES	
1	2	3	4	5	6	7	
01	GENERAL REQUIREMENTS	RECD	F&I	F	Only	F&I	As required by local Building Dept., Fire Dept., Health, and other departments. GC is responsible for obtaining. Owner reimburses GC.
1	BUILDING PERMITS						As required by local Building Dept., Fire Dept., Health, and other departments. GC is responsible for obtaining. Owner reimburses GC.
2	PERMITS						As required by local Building Dept., Fire Dept., Health, and other departments. GC is responsible for obtaining. Owner reimburses GC.
3	TEMPORARY UTILITIES						As required by local Building Dept., Fire Dept., Health, and other departments. GC is responsible for obtaining. Owner reimburses GC.
4	CLEAN WORK AREA						Full time on site supervisor - provide C of O through opening. Two copies of "as-built" operations manual, warranties and lien waivers - Sworn Statement and C of O.
5	INSURANCE						As required by L.I. & B.W.R. - GC to furnish general liability, auto, worker's comp. & Builders risk.
6	PROTECTION						Protection for floor finishes after installation.
7	SPECIAL INSPECTIONS						Contract by owner and GC to coordinate.
02	SITE WORK	RECD	F&I	F	Only	F&I	As required by civil drawings.
1	SITE EVALUATION						As required by civil drawings.
2	SITE PAVING						As required by civil drawings.
3	SITE DRAINAGE AND UTILITIES						As required by civil drawings.
4	EROSION CONTROL						As required by civil drawings.
5	LANDSCAPE AND IRRIGATION						As required per plans.
6	GAS SERVICE & MANIFOLD						Service & manifold connection of building - GC to coordinate meter & final connection with Utility Company.
7	WATER SERVICE (DOM AND FIRE)						As required per plans - GC to coordinate meter & final connection with Utility Company.
8	ELECTRICAL SERVICE & METER						Service per plans - GC to coordinate meter & final connection with Utility Company.
03	CONCRETE WORK	RECD	F&I	F	Only	F&I	As required by Structural, Civil and Architectural plans.
1	CONCRETE SLAB						As per Structural, Civil and Architectural plans.
2	CONCRETE FLOORS, WALKS & PATIOS						As per Structural, Civil and Architectural plans.
3	CONCRETE SEALS						As per Structural, Civil and Architectural plans.
4	CONCRETE CURBS						Refer to Bar Plans for de wall curb, coordinate radius with millwork vendor for bar wall coordination.
04	MASONRY	RECD	F&I	F	Only	F&I	As indicated on Architectural plans.
1	BRICK MASONRY						As per Structural and Architectural plans.
2	BRICK MASONRY						As per Structural and Architectural plans.
05	METALS	RECD	F&I	F	Only	F&I	As required by Structural, Civil and Architectural plans.
1	STRUCTURAL STEEL						Any struct. Steel associated w/ wall & roof penetration support framing - include coils & shop drawings.
2	COLD FORM FRAMING						Any struct. Steel associated w/ wall & roof penetration support framing - include coils & shop drawings.
3	MISCELLANEOUS METALS						As required to complete project per plans.
4	STILES						Framing at 16" oc per plan designation.
5	INTERIOR WALLS						Framing at 16" oc per plan designation.
6	EXTERIOR WALLS						Per plans.
7	FLOORING						Heavy duty wall standards & shelf brackets in white finish - manager's office.
8	WALL STANDARDS						GC to provide or required for protection at delivery entrance steel posts for 1/2" wall & rail supports provided by GC.
9	RECLAMATION, EXPOSED & ORNAMENTAL						GC to provide or required for protection at delivery entrance steel posts for 1/2" wall & rail supports provided by GC.
10	STAINLESS STEEL						GC to provide or required for protection at delivery entrance steel posts for 1/2" wall & rail supports provided by GC.
06	WOOD & PLASTICS	RECD	F&I	F	Only	F&I	As required by Structural, Civil and Architectural plans.
1	WALL BECKING						Framing and 2x blocking as required - see floor plan, wall elevations & sections for locations.
2	PLYWOOD						Framing - exterior grade for sheathing.
3	WOOD TRIM						profiles per plans.
4	WOOD WALL CAPS & DORMER RAELS						profiles per plans.
5	WOOD BALUNES						profiles per plans.
6	FRP WALL PANELS						Fiberglass reinforced panels gently pebbled, high gloss finish as noted on plans.
7	COUNTERTOPS						Solid surface.
8	ARCHITECTURAL CASEWORK						Solid surface counter & cabinets.
9	FOOD SERVICE COUNTER						Solid surface counter & cabinets.
10	BAKERY COUNTER & CABINETS						Solid surface counter & cabinets.
11	SODA MACHINE CABINET						Solid surface counter & cabinet.
12	FRONT BACK BAR						Solid surface back bar top & cabinets w/ adjustable shelves per plans. Bar wall is part of Millwork Package.
13	OFFICE COUNTER, CABINETS, SHELVES						Counter, cabinets & shelves, provide all parts & support gages.
14	VANITY COUNTERS						Solid surface counter and splash provided by Millwork Vendor. GC to provide under mount sinks, faucets, and associated parts, provide Millwork Vendor with dimensions.
07	THERMAL MOISTURE	RECD	F&I	F	Only	F&I	As required by Structural, Civil and Architectural plans.
1	SOIL PROOFING						Foundation, wall and roof insulation as required per plans and specifications - Refer Mechanical Drawings for Dust Insulation.
2	INSULATION						As per plans and manufacturer's details and specifications. (Drift or Slope)
3	EIFS / STUCCO						As per plans and manufacturer's details and specifications. (Drift or Slope)
4	ROOFING & FLASHING						As required per plans and specifications.
5	SEALANTS						As required per plans and specifications.
6	WATERPROOF MEMBRANE						Install in kitchen, office, bar and restrooms per wall finish types and finish plan.
08	DOORS & HARDWARE	RECD	F&I	F	Only	F&I	As required by Structural, Civil and Architectural plans.
1	FLM DOORS & DOOR FRAMES						As per plans and schedules.
2	WOOD DOORS						As per plans and schedules.
3	DOOR HARDWARE						See hardware schedule.
4	ALUM ENRANCE VESTIBULE & PATIO						As required per plans and specifications.
5	ALUMINUM SUBFLOOR						As required per plans and specifications.
6	MIRRORS						1/4" tempered mirrors.
09	FINISHES	RECD	F&I	F	Only	F&I	As required by Structural, Civil and Architectural plans.
1	WALLBOARD						5/8" gyp. wallboard - tape & sand exposed surfaces ready for finishes - see plans for wall types & heights. Prime and 3 coats paint - See Specifications for finish requirements.
2	WATER RESISTANT GYP. WALLBOARD						5/8" of all wet walls and behind wall tile - tape & sand to receive finish where indicated on plans.
3	CONCRETE BACKER BOARD						5/8" backer board - all kitchen & toilet walls - see wall finishes for additional information.
4	ROOFING UNDERLAY						As indicated on plans and schedule.
5	STANDARD CONCRETE						See finish plan and schedule - install per manufacturer's recommendations.
6	WALL TILE						Receive, inventory & install tile - grout, transitions & setting material.
7	WALL COVERINGS/WALL PAPER						See finish plan and schedule.
8	MANSOOT						As per plans and schedules.
9	BOSS						As per plans and schedules.
10	CEILING TILE						Receive & install to match adjacent floor tile, grout and setting material.
11	CUT TILE						Receive & install to match adjacent floor tile, grout and setting material.
12	FRAN						Structure, wood, decks, conditions, walls & soffits above hand board - exposed walls, doors & frames.
13	SPAN						All exposed wood trim and doors, stain to be applied as noted on the finish schedule. All pieces to match.
14	CEILING AND GRD						Refer to Finish Schedule.
15	MINERAL FIBER						As per plans and schedules.
16	WALL GRAPHICS						Furnished by owner, installed by GC. GC to provide blocking as needed.
17	WOOD TRIM						As per plans and schedules.
10	SPECIALTIES	RECD	F&I	F	Only	F&I	As required by Structural, Civil and Architectural plans.
1	TOILET ACCESSORIES						Receive, inventory & install - As per plans and schedule.
2	DWPPER TABLE						Receive & install Koolha horizontal changing table - Mount @ 34" AFF to top of open table.
3	ACCESSIBILITY SIGNAGE						Per local jurisdiction.
4	SIGNS AND MARKINGS						Coordinate connections, electrical and backing with sign vendor.
5	FIRE EXTINGUISHERS						Per local Fire Marshal & building code (4 min. required - 3 ABC & 1 K, public areas to have recessed cabinets).
6	HAND BOX						Per local Fire Marshal.
11	EQUIPMENT	RECD	F&I	F	Only	F&I	As required by Structural, Civil and Architectural plans.
1	EXTERIOR SIGNAGE						GC to provide or required for protection at delivery entrance steel posts for 1/2" wall & rail supports provided by GC.
2	KITCHEN EQUIPMENT						GC to provide or required for protection at delivery entrance steel posts for 1/2" wall & rail supports provided by GC.
3	COOLERS/FREEZERS						Vendor to provide, GC to un-pack, assemble, install as required.
4	DISHWASHER						GC to supply install per manufacturer's specifications. 22 gpa. SSI, wall cladding at exhaust hood by vendor installed by GC.
5	EXHAUST HOOD						As per plans and schedule - GC to provide grease recovery connections.
6	EXHAUST HOODS						As per plans and schedule.
7	WALL MOUNTED EQUIPMENT						GC responsible for additional fire retardant blocking.
8	WALL MOUNTED EQUIPMENT						As per plans and schedules.
9	DISHWASHER						As per plans and schedules.
10	WATER HEATER						GC to provide or required for protection at delivery entrance steel posts for 1/2" wall & rail supports provided by GC.
11	RECYCLERS/CONTAINERS						GC to provide or required for protection at delivery entrance steel posts for 1/2" wall & rail supports provided by GC.
12	GREASE TRAP/INTERCEPTOR						GC to provide or required for protection at delivery entrance steel posts for 1/2" wall & rail supports provided by GC.
13	GREASE CONTAINMENT SYSTEM						Furnished and installed by G.C. per plumbing and electrical drawings, G.C. to make connections and coordinate with vendor.
12	FURNISHINGS	RECD	F&I	F	Only	F&I	As required by Structural, Civil and Architectural plans.
1	MANAGERS OFFICE MISC. EQUIPMENT						Receive, un-pack, install - coordinate with owner for location of items.
2	TABLES, CHAIRS & BENCHES						GC to receive, un-pack, assemble, and install. 2" floor window for unloading, if more GC pays additional freight costs.
3	OFFICE CHAIRS						Receive, un-pack, install - listen note to floor and steel structure base.
4	FAX MACHINE						
13	SPECIAL CONSTRUCTION	RECD	F&I	F	Only	F&I	As required by Structural, Civil and Architectural plans.
14	CONVEYING SYSTEMS	RECD	F&I	F	Only	F&I	As required by Structural, Civil and Architectural plans.
15	MECHANICAL	RECD	F&I	F	Only	F&I	As required by Structural, Civil and Architectural plans.
1	SPRINKLER SYSTEM						System to be design built, vendor must provide equipment plans & specifications per local codes, GC to coordinate inspection and test - Provide architect with final approved design plan for files.
2	ANSL SYSTEM						GC to coordinate, schedule installation and testing through hand vendor.
3	PLUMBING						Connect to system - see plumbing and civil sheets for location, coordinate w/ local utility.
4	WATER						Connect to system - see plumbing and civil sheets for location, coordinate w/ local utility.
5	WASTE						As per plans and specifications - see plumbing sheets for location, coordinate w/ local utility.
6	VENT						Provide lines in work rooms - installation in all work rooms - install per required in code, Beer, and Frezer Walk-ins.
7	CONDENSATE PIPING						Install w/ 1/4" in 12" pitch of floor in open areas - Elevation to match finished floor under all equipment.
8	FLOOR DRAINS & FLOOR SINKS						See plumbing and civil sheets, install per local jurisdiction.
9	GRAB BAR						See plumbing sheets.
10	WALK OFF MATS						See plumbing sheets.
11	CIRCULATING PUMP						See plumbing sheets.
12	WATER HEATER						See plumbing sheets.
13	WATER HEATER						See plumbing sheets.
14	KITCHEN EQUIPMENT						Make rough in & final connections.
15	GAS SUPPLY SYSTEM						Connect to system at manifold. Make final connection to kitchen equipment. Coordinate w/ local utility, civil drawings.
16	HVAC						Equipment to include RTU, curb & accessories. See mechanical sheets.
17	AIRU EQUIPMENT						See mechanical sheets.
18	DOCK WORK						See mechanical sheets.
19	OFFSETS						See mechanical sheets.
20	TEMPERATURE CONTROLS						See mechanical sheets.
21	SMOKER / CO DETECTORS						See mechanical sheets.
22	FIRE ALARM						GC to schedule and coordinate through hood vendor.
23	TOILET EXHAUST						See mechanical sheets.
24	EXHAUST HOOD						GC to install per manufacturer's specifications. Manufacturer suggested connections and terminations shall take precedence over drawings unless otherwise specified.
16	ELECTRICAL	RECD	F&I	F	Only	F&I	As required by Structural, Civil and Architectural plans.
1	SPENCER						See electrical and civil drawings and specifications.
2	DISTRIBUTION SYSTEM						As per Electrical plans and specifications.
3	PANTRY TRANSFORMERS						See electrical sheets.
4	LIGHT FIXTURES & LAMPS						GC - Review, inventory, un-pack & install - see fixture schedule for types. GC responsible to coordinate warranty issues with sub and vendor.
5	LIGHTING CONTROLS						See electrical sheets. GC responsible to coordinate warranty issues with sub and vendor.
6	KITCHEN EQUIPMENT						GC - provide final connection.
7	PANTRY & VAN CONDITIONS						Furnish 2/4 corded numerals w/ pull string - GC - termination and wire by owner's vendor - See Electrical plans for location, coordinate with owner's vendor.
8	FIRE LIFE SAFETY ALARMS						System to be design built, vendor must provide equipment plans & specifications per local codes. GC to provide conduits and pull strings.
9	SONAR						GC to provide final connection.
10	BURGULAR ALARM						GC to furnish conduit & boxes. GC to coordinate installation. Burglar alarm required to be complete prior to TV installation.
11	EXHAUST HOOD						GC to install per manufacturer's specifications. Manufacturer suggested connections and terminations shall take precedence over drawings unless otherwise specified.
NOTES							
1. GC AND OWNER'S VENDORS MUST COMPLETE THE FOLLOWING ITEMS TO OBTAIN A FINAL C OF O							
A. TELEPHONE SYSTEM OPERATIONAL							
B. HOOD ANSLE FIRE SUPPRESSION SYSTEM OPERATIONAL							
C. KITCHEN REFRIGERATION OPERATIONAL (FOR HEALTH INSPECTION)							

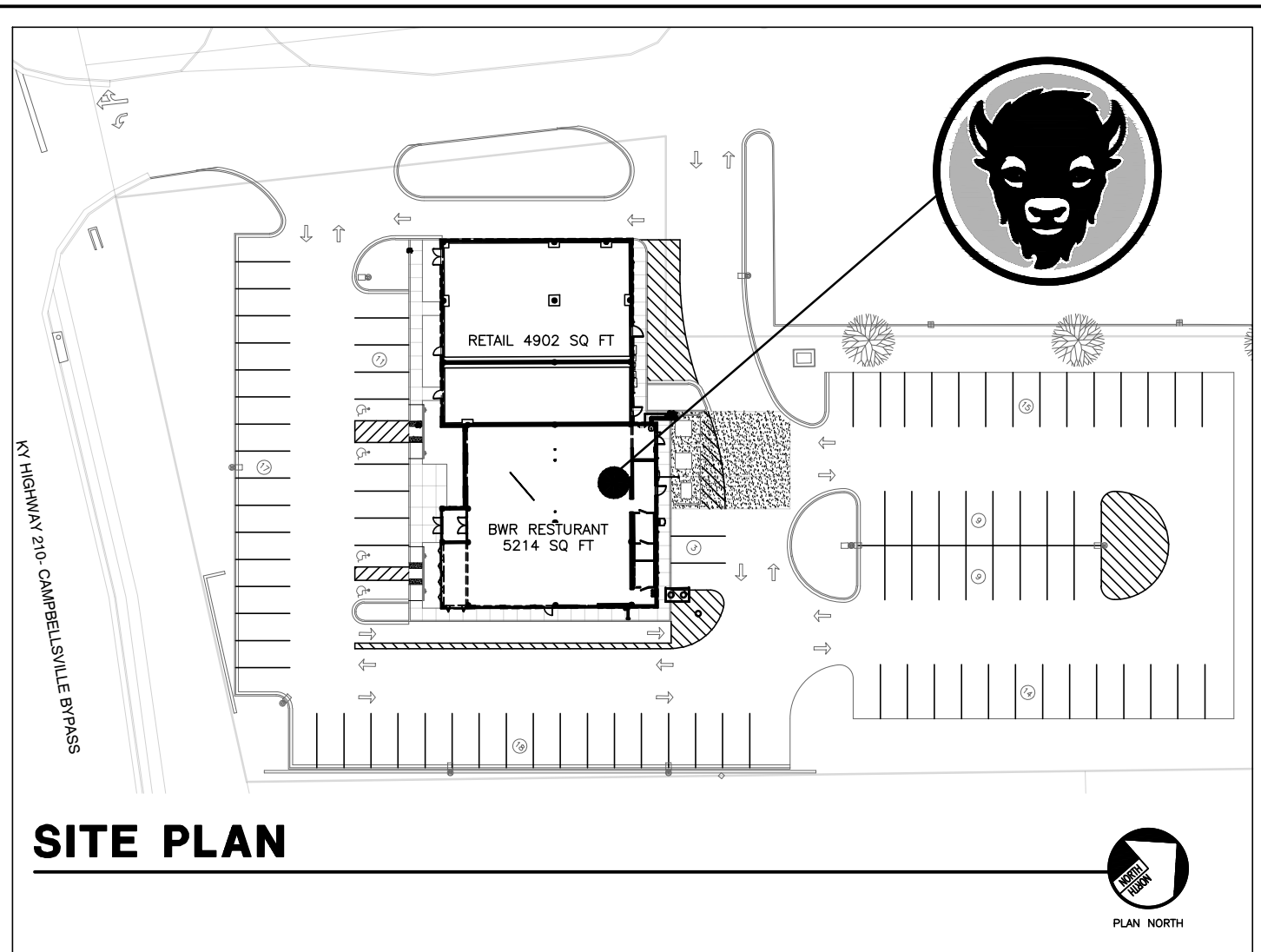
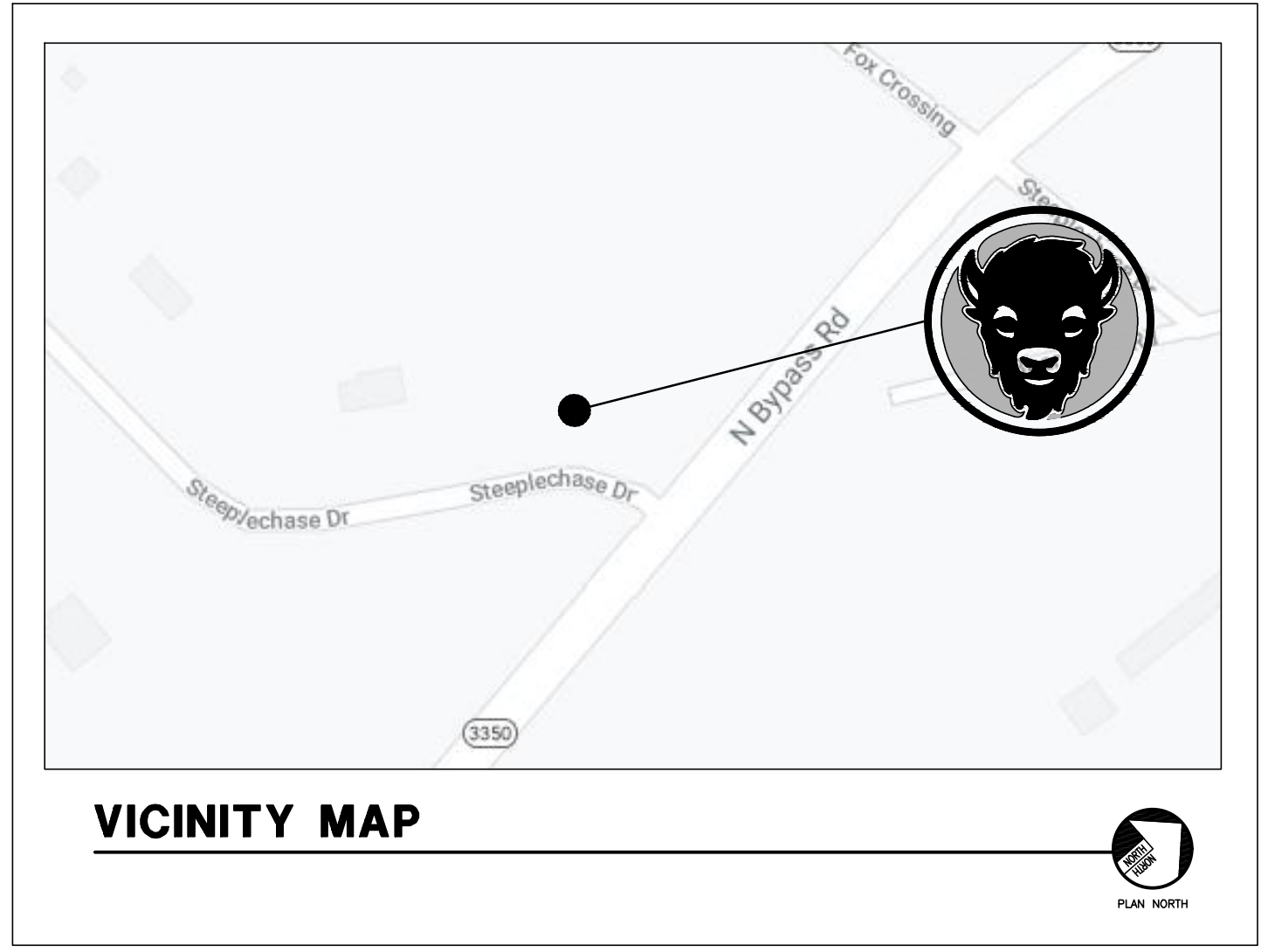

PROJECT CONTACT INFO

FRANCHISEE: SHAWN HILL C-VILLE WINES, LLC 1012 GRANITE DR. BARDSTOWN, KY 40004	PROJECT MANAGER: LACE DEJOURNET INTERTECH DESIGN SERVICES INC. 9675 MONTGOMERY RD. CINCINNATI, OH 45242 PHONE: (513)791-5588 FAX: (513) 792-7923 EMAIL: LDEJOURNET@intertechdesign.net	ARCHITECT: INTERTECH DESIGN SERVICES INC. 9675 MONTGOMERY RD. CINCINNATI, OH 45242 PHONE: (513)791-5588 FAX: (513) 792-7923	STRUCTURAL ENGINEER: STEVEN HUDSPER HUDSPER ENGINEERING, LLC 6163 SUGARCREAK COURT LIBERTY, MO, OH 45011 PHONE: (513) 417-4300	CIVIL ENGINEER: KENDAL WISE VANTAGE ENGINEERING PLC 2038 DANVILLE ROAD HARRISBURG, KY 40330 PHONE: (859) 734-0560
---	--	---	--	---

UTILITY & PERMITTING CONTACTS

PLANNING/ZONING DEPARTMENT: CAMPBELLVILLE PLANNING AND DEVELOPMENT 110 S. COLUMBIA AVE., STE B CAMPBELLVILLE KY, 42718 EMAIL: CTUCKER@CAMPBELLVILLEKY.GOV	BUILDING DEPARTMENT: STATE OF KENTUCKY BUILDING CODES ENFORCEMENT 100 WEST BROWNWAY FRANKFORD KY, 40601 PHONE: (502)573-0373	HEALTH DEPARTMENT: TAYLOR COUNTY HEALTH DEPARTMENT 1880 N BYPASS ROAD CAMPBELLVILLE KY, 42718 EMAIL: CHRIS.TAYLOR@CAMPBELLVILLEKY.GOV PHONE: (270)-465-4131
--	---	---

CODE ANALYSIS

APPLICABLE CODES:	IBC 2018 BUILDING CODE
BUILDING:	IPC 2018 PLUMBING CODE
PLUMBING:	IPC 2018 MECHANICAL CODE
MECHANICAL:	MC 2018 ELECTRICAL CODE
ELECTRIC:	ASHRAE 90.1 2018 ENERGY CODE
ENERGY:	

APPLICABLE CODES:	IBC 2018 BUILDING CODE
BUILDING:	IPC 2018 PLUMBING CODE
PLUMBING:	IPC 2018 MECHANICAL CODE
MECHANICAL:	MC 2018 ELECTRICAL CODE
ELECTRIC:	ASHRAE 90.1 2018 ENERGY CODE
ENERGY:	

APPLICABLE CODES:	IBC 2018 BUILDING CODE
BUILDING:	IPC 2018 PLUMBING CODE
PLUMBING:	IPC 2