

- LAYOUT NOTES:**
- PRIOR TO CONSTRUCTION, THE CONTRACTOR IS RESPONSIBLE FOR ENSURING ALL REQUIRED PERMITS AND APPROVALS HAVE BEEN OBTAINED. NO CONSTRUCTION SHALL BEGIN PRIOR TO THE CONTRACTOR RECEIVING AND REVIEWING THE REQUIRED PERMITS AND APPROVALS.
 - PRIOR TO CONSTRUCTION, THE CONTRACTOR SHALL FIELD VERIFY ALL EXISTING DRAINAGE AND UTILITY CONNECTIONS TO ENSURE THEY CAN BE PROPERLY CONNECTED.
 - IN THE EVENT OF A CONFLICT BETWEEN THIS DRAWING AND ANY OTHER DRAWING AND/OR SPECIFICATION, THE ENGINEER SHALL BE NOTIFIED IMMEDIATELY FOR CLARIFICATION.
 - UNLESS NOTED OTHERWISE, THE DIMENSIONS AND COORDINATES SHOWN HEREON ARE TO THE EDGE OF THE RIGID CONCRETE, EDGE OF ASPHALT, FACE OF CURB, OR OUTSIDE FACE OF BUILDINGS/STRUCTURES.
 - ALL RIGID AND/OR FLEXIBLE PAVEMENT AND STONE SHALL MEET THE MATERIALS, EQUIPMENT, CONSTRUCTION, & TESTING REQUIREMENTS OF THESE DRAWINGS AND/OR THE KENTUCKY TRANSPORTATION CABINET STANDARD SPECIFICATIONS.
 - ALL SETBACKS SHALL BE IN ACCORDANCE WITH THE LOCAL ZONING ORDINANCE.
 - ALL PAVEMENT MARKINGS WITHIN THE DEVELOPMENT SHALL BE PAINTED. ALL PAVEMENT MARKINGS ON CITY OR STATE R/W SHALL CONFORM TO THE REGULATIONS OF THEIR RESPECTIVE OWNER.
 - ANY WORK WITHIN THE KYTC R/W WILL REQUIRE AN ENCROACHMENT PERMIT. ALL DISTURBED PORTIONS OF THE RIGHT OF WAY SHALL BE RESTORED TO GRASS AS PER KENTUCKY DEPARTMENT OF HIGHWAYS STANDARD SPECIFICATIONS FOR ROAD AND BRIDGE CONSTRUCTION (LATEST EDITION).
 - THE LOCATIONS OF THE EXISTING UTILITIES SHOWN ON THESE DRAWINGS ARE APPROXIMATE. THE EXACT LOCATIONS SHALL BE DETERMINED IN THE FIELD BY COORDINATING WITH THE RESPECTIVE UTILITY COMPANIES INVOLVED. PROVIDE ALL NECESSARY PROTECTIVE MEASURES TO SAFEGUARD THE EXISTING UTILITIES FROM DAMAGE DURING THE CONSTRUCTION OF THIS PROJECT.
 - ALL CURB STOPS AND CURB CUTS ABUTTING TRAVELED WAYS SHALL TAPER TO ASPHALT GRADE AT A MIN. 4:1 SLOPE.

SITE LEGEND

- → = LIGHT POLES/SECURITY LIGHT
- ⊙ = BENCHMARK - IRON PIN W/ BLUE CAP
- = PROPOSED STORM PIPE
- ▭ = CONCRETE AREA
- = PROPERTY LINES

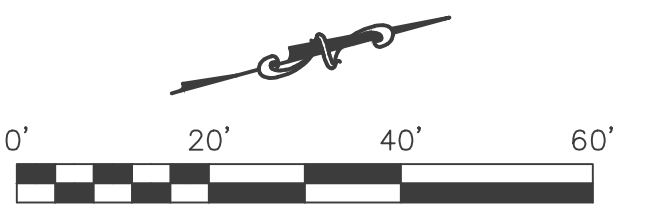

BLEND PAK BLDG EXPANSION
PO BOX 458
BLOOMFIELD, KY 40008

BCD INC.
1962 FILIATREAU LN
BARDSTOWN, KY 40004



LEBANON OFFICE:
335 N. WOODLAWN AVE.
LEBANON, KY 40033

NATHAN ALLAN KING
P.E. #24283 P.L.S. #3831
BUSINESS: (270) 692-0089
MOBILE: (270) 590-4603
Nathan@mkw.net

REVISIONS:	DATE:

SCALE: 1" = 20' **DATE:** 01-23-23

SHEET: **C1.01**

LAYOUT

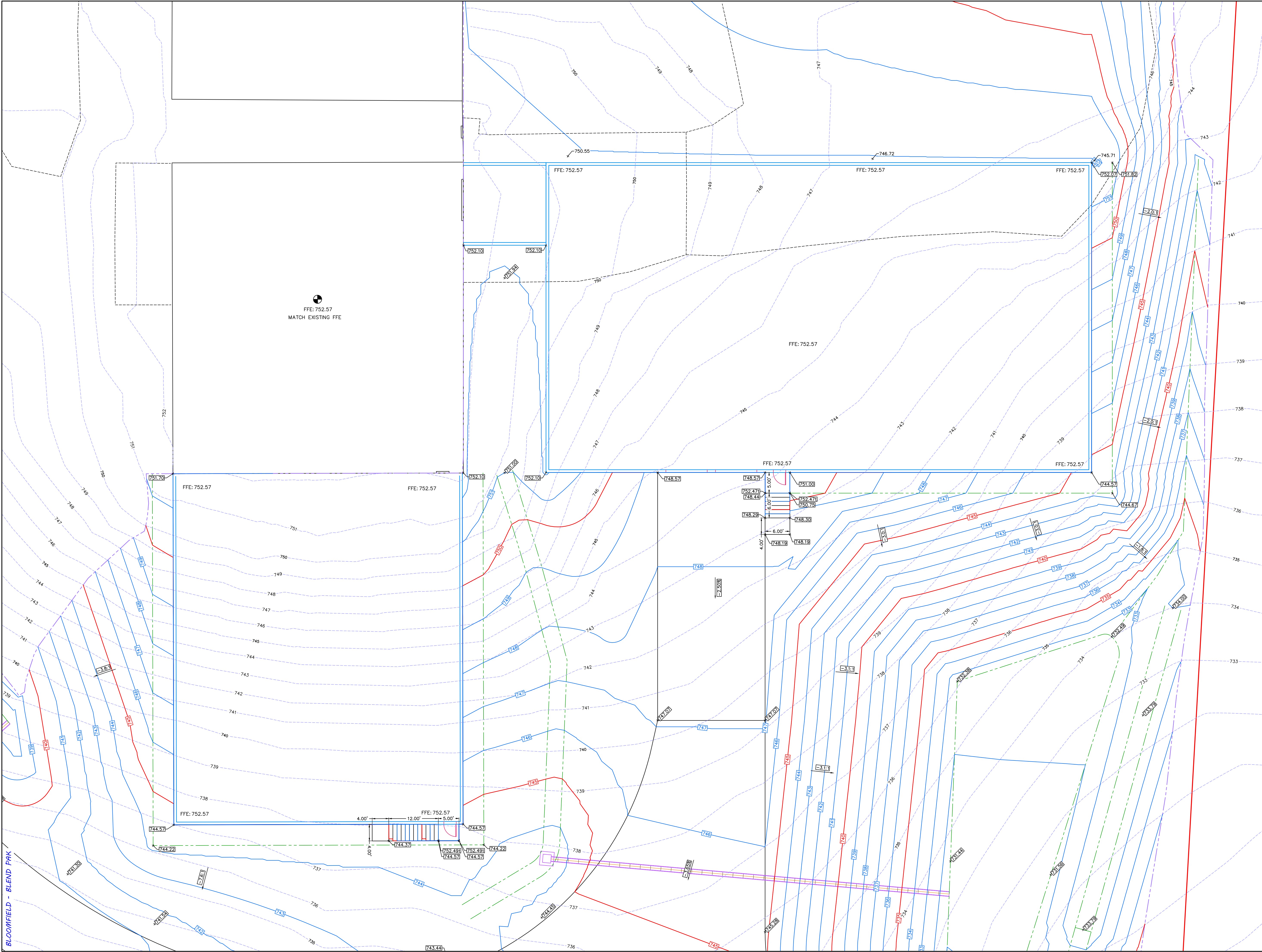

- DRAIN & GRADE NOTES:**
1. PRIOR TO CONSTRUCTION, THE CONTRACTOR IS RESPONSIBLE FOR ENSURING ALL REQUIRED PERMITS AND APPROVALS HAVE BEEN OBTAINED. NO CONSTRUCTION SHALL BEGIN PRIOR TO THE CONTRACTOR RECEIVING AND REVIEWING THE REQUIRED PERMITS AND APPROVALS.
 2. PRIOR TO CONSTRUCTION, THE CONTRACTOR SHALL FIELD VERIFY ALL EXISTING DRAINAGE AND UTILITY CONNECTIONS TO ENSURE THEY CAN BE PROPERLY CONNECTED.
 3. NO DISTURBANCE TO THE NATURAL GROUND SHALL TAKE PLACE PRIOR TO HAVING THE PROPOSED EROSION CONTROL PLAN APPROVED AND IN PLACE.
 4. IN THE EVENT OF A CONFLICT BETWEEN THIS DRAWING AND ANY OTHER DRAWING AND/OR SPECIFICATION, THE ENGINEER SHALL BE NOTIFIED IMMEDIATELY FOR CLARIFICATION.
 5. UNLESS NOTED OTHERWISE, THE SPOT ELEVATIONS SHOWN ARE TO THE BOTTOM FACE OF CURB OR SIDEWALK.
 6. THE AGGREGATE BASE & ASPHALT COURSES SHALL MEET THE MATERIALS, EQUIPMENT, CONSTRUCTION, & TESTING REQUIREMENTS OF THESE DRAWINGS AND THE CURRENT EDITION OF THE KENTUCKY TRANSPORTATION CABBINET STANDARD SPECIFICATIONS.
 7. ALL SETBACKS SHALL BE IN ACCORDANCE WITH THE LOCAL ZONING ORDINANCE.
 8. THE LOCATIONS OF THE EXISTING UTILITIES SHOWN ON THESE DRAWINGS ARE APPROXIMATE. THE EXACT LOCATIONS SHALL BE DETERMINED IN THE FIELD BY COORDINATING WITH THE RESPECTIVE UTILITY COMPANIES INVOLVED. PROVIDE ALL NECESSARY PROTECTIVE MEASURES TO SAFEGUARD THE EXISTING UTILITIES FROM DAMAGE DURING THE CONSTRUCTION OF THIS PROJECT.
 9. THE CONTRACTOR SHALL VERIFY POSITIVE FLOW FOR ALL STORM SEWER PIPE. DISCREPANCIES SHALL BE BROUGHT TO THE ATTENTION OF THE ENGINEER IMMEDIATELY.
 10. ALL DISTURBED AREAS OUTSIDE THE PROJECT LIMITS, INCLUDING ADJOINING PROPERTIES AND/OR RIGHT-OF-WAY SHALL BE REPAIRED, SEEDED, AND STRAWED.

SITE LEGEND

- = LIGHT POLES/SECURITY LIGHT
- BM = BENCHMARK
- +690.00 = PROPOSED GRADE SPOT SHOT
- +690.001 = INDICATES TOP OF CURB/SIDEWALK
- +690.00 = EXISTING GRADE SPOT SHOT
- = PROPOSED STORM PIPE
- = CONCRETE AREA
- = PROPERTY LINES
- = 690 = EXISTING CONTOURS
- = 690 = PROPOSED CONTOURS
- = DISTURB LIMITS

0' 10' 20' 30'

Kentucky 811

BLOOMFIELD - BLEND PAK

BLEND PAK BLDG EXPANSION
PO BOX 458
BLOOMFIELD, KY 40008

BCD INC.
1962 FILIATREAU LN
BARDSTOWN, KY 40004

KWM ENGINEERING & LAND SURVEYING

LEBANON OFFICE:
335 N. WOODLAWN AVE.
LEBANON, KY 40033

NATHAN ALLAN KING
P.E. #24283 P.L.S. #3831
BUSINESS: (270) 692-0089
MOBILE: (270) 590-4603
Nathan@mkwm.net

REVISIONS:	DATE:

SCALE: 1" = 10'

DATE: 01-23-23

SHEET: C2.02

PROPOSED GRADE & DRAIN

EROSION CONTROL NOTES:

1. THE BEST MANAGEMENT PRACTICE (BMP) PLAN MUST BE IMPLEMENTED BEFORE ANY LAND-DISTURBING ACTIVITIES. SEDIMENT CONTROL SUCH AS TRAPS AND SILT-FENCES MUST BE INSTALLED BEFORE LAND CLEARING, EXCAVATION, OR PLACEMENT OF FILL MATERIAL.
2. DETENTION BASINS, IF USED, MUST BE CONSTRUCTED FIRST AND MUST PERFORM AS SEDIMENT BASINS UNTIL THE CONTRIBUTING DRAINAGE AREA IS SEEDDED AND STABILIZED. OUTLETS MUST BE MODIFIED, IF NECESSARY, TO MAXIMIZE DETENTION AND SEDIMENT REMOVAL DURING CONSTRUCTION.
3. TEMPORARY SEDIMENT TRAPS WITH ROCK OR EARTHEN DIKES OR OTHER APPROVED CONTROLS MUST BE INSTALLED DOWNGRADIENT OF HEAVILY ERODED AREAS AS NEEDED TO PREVENT SEDIMENT FROM LEAVING THE SITE.
4. INSTALL CONSTRUCTION ENTRANCE/EXIT TO MINIMIZE THE TRACKING OF MUD, SOIL, AND ROCK FROM CONSTRUCTION AREAS ONTO PUBLIC ROADWAYS. SOIL AND ROCK TRACKED ONTO THE ROADWAY MUST BE REMOVED DAILY.
5. SOIL STOCKPILES MUST BE LOCATED AWAY FROM STREAMS, PONDS, SWALES AND CATCH BASINS. STOCKPILES MUST BE SEEDDED, MULCHED, AND ADEQUATELY CONTAINED THROUGH THE USE OF SILT FENCE. STOCKPILES SHALL HAVE TEMPORARY VEGETATION ESTABLISHED IF IT IS TO BE LEFT FOR 21 DAYS OR MORE.
6. ALL STREAM CROSSINGS MUST USE PROPERLY DESIGNED LOW-WATER CROSSING STRUCTURES AUTHORIZED UNDER A USACE CLEAN WATER ACT SECTION 404 PERMIT.
7. SEDIMENT-LOADED WATER ENCOUNTERED DURING TRENCHING, BORING, OR OTHER EXCAVATION ACTIVITIES MUST BE PUMPED TO A SEDIMENT TRAPPING DEVICE AND CLEANED BEFORE BEING DISCHARGED. DISCHARGES TO STORM DRAINS, DITCHES, OR WATER BODIES MUST BE COVERED UNDER A KPDOS GENERAL PERMIT.
8. ALL BARE SOIL AREAS MUST BE STABILIZED ACCORDING TO THE FOLLOWING SCHEDULE:
 - FINAL GRADE AREAS BROUGHT TO FINAL GRADE MUST BE STABILIZED WITHIN 14 DAYS.
 - TEMPORARY GRADE AREAS NOT SUBJECT TO ACTIVE CLEARING, EXCAVATION, GRADING, OR FILL ACTIVITIES FOR 21 DAYS, MUST BE STABILIZED WITH TEMPORARY OR PERMANENT SEEDING OR MULCHING WITHIN 14 DAYS.
9. CLEARING AND GRUBBING SHOULD BE LIMITED TO THE SMALLEST POSSIBLE AREA. EXISTING TREES AND VEGETATION SHALL BE PRESERVED TO THE MAXIMUM EXTENT POSSIBLE.
10. VEGETATIVE BUFFER STRIPS IN COMBINATION WITH PERIMETER CONTROLS SHALL BE USED FOR THE PROTECTION OF ADJACENT PROPERTIES, STREAMS AND RIGHTS OF WAY.
11. ALL AREAS IDENTIFIED AS STREAMS, STREAM BUFFERS, WETLANDS, SINKHOLES, CRITICAL HABITAT, PERMANENT NATIVE VEGETATION, OR PROTECTED AREAS MUST BE FLAGGED AS OFF-LIMITS TO VEHICLES AND EQUIPMENT.
12. GOOD HOUSEKEEPING PRACTICES MUST BE APPLIED TO PREVENT CONTAMINATED RUNOFF OR OTHER IMPACTS FROM PAINT OR CONCRETE WASTES, FUELS AND OILS, TRASH AND LITTER, OR OTHER MATERIALS.
13. SILT FENCES, DITCH CHECKS, NON-PERMANENT SEDIMENT TRAPS, AND OTHER TEMPORARY CONTROLS MUST BE REMOVED AFTER VEGETATION IN UPGRADE AREAS IS ESTABLISHED AND DITCHES ARE STABLE.
14. GOOD HOUSEKEEPING MEASURES FOR MATERIALS STORAGE AND HANDLING, VEHICLE FUELING AND MAINTENANCE, SPILL RESPONSE AND CLEANUP, AND WASTE MANAGEMENT MUST BE FOLLOWED TO ENSURE THAT RUNOFF FROM THE SITE IS FREE OF CONTAMINANTS.
15. ALL BMPs WILL BE SELECTED, INSTALLED, OPERATED, AND MAINTAINED ACCORDING TO KY DOW GUIDELINES, MANUFACTURER'S REQUIREMENTS, OR STANDARD INDUSTRY PRACTICE, AS APPROPRIATE.
16. SPECIAL TECHNIQUES SUCH AS RIPRAP, TURF REINFORCEMENT, AND OTHER METHODS SHALL BE USED ON STEEP SLOPES AND CHANNELS TO ENSURE STABILIZATION.
17. DURING WINTER MONTHS WHEN THERE IS NO CONSTRUCTION ACTIVITY, THE ENTIRE SITE SHALL BE STABILIZED USING A HEAVY MULCH LAYER OR OTHER METHODS THAT DO NOT REQUIRE GERMINATION TO CONTROL SEDIMENT AND PREVENT EROSION.
18. DUST CONTROL TECHNIQUES SHALL BE USED TO PREVENT THE BLOWING OF DUST DURING LAND DISTURBANCE, DEMOLITION AND OTHER CONSTRUCTION ACTIVITIES.
19. DIVERSION OF UPLAND RUNOFF PAST DISTURBED SLOPES SHALL BE IMPLEMENTED WHEN NECESSARY.
20. EFFECTIVE DEBRIS AND TRASH MANAGEMENT SHALL BE REQUIRED.
21. SILT FENCES ARE TO BE CLEANED OUT WHEN THEY BECOME ONE THIRD FULL.
22. AFTER EVERY RAIN IN EXCESS OF 1/4", ALL EROSION CONTROL MEASURES ARE TO BE INSPECTED AND CLEANED OR REPAIRED AS NECESSARY.

BEST MANAGEMENT PRACTICES:

1. IT IS THE INTENTION OF THIS PLAN TO EFFECTIVELY CONTROL EROSION OF DISTURBED SOILS. HOWEVER NO PLAN CAN BE MADE THAT DETAILS ALL POSSIBLE CONTROL MEASURES THROUGHOUT CONSTRUCTION. IT IS THE CONTRACTOR'S RESPONSIBILITY TO MINIMIZE ALL EROSION USING THESE MEASURES AS WELL AS ANY ADDITIONAL MEASURES REQUIRED TO CONTROL RUNOFF.
2. THE CONTRACTOR IS TO TAKE IMMEDIATE ACTION TO CLEAN UP SPILLS OF ILLICIT MATERIAL AND MUST MAINTAIN OIL AND GREASE ABSORBING MATERIALS ON-SITE. RUBBISH, TRASH, GARBAGE, LITTER, ETC. ARE TO BE DEPOSITED IN SEALED CONTAINERS. THE CONTRACTOR IS TO CONTROL DUST FROM THE SITE. IF CONCRETE TRUCKS WASH OUT ON SITE, THE WASH WATER SHALL BE PLACED IN AN AREA WHERE IT CAN NOT MAKE ITS WAY OFF SITE.
3. CONTRACTOR SHALL SECURE THE K-P.D.E.S. NOTIFICATION OF COVERAGE PRIOR TO LAND DISTURBING ACTIVITIES. THE NOI MUST BE SUBMITTED AS REQUIRED BY THE KENTUCKY DIVISION OF WATER (KDOW).
4. THE CONTRACTOR IS TO KEEP A SIGNED AND SEALED EROSION CONTROL PLAN ON SITE AND MAKE IT AVAILABLE TO INSPECTORS AS REQUIRED.
5. ANY DEVIATIONS FROM THIS PLAN SHALL BE MARKED ON SAME WITH AN EXPLANATION OF WHY IT WAS NEEDED.
6. IF A SPILL OF AN ILLICIT MATERIAL ENTER A WATERWAY OR STORM SEWER, CONTACT THE KDOW 502-564-2380.
7. EROSION CONTROL BLANKET (ECB) REQUIRED FOR ALL SLOPES STEEPER THAN 4:1. RIP-RAP SLOPES REQUIRED FOR ALL SLOPES STEEPER THAN 3:1.

SITE LEGEND

- = PROPOSED STORM PIPE
- = CONCRETE AREA
- = PROPERTY LINES
- = EXISTING CONTOURS
- = PROPOSED CONTOURS
- = DISTURB LIMITS

EROSION CONTROL LEGEND

SEE SHEET C4-02 FOR DETAILS

- = SILT FENCE
- = CATCH BASIN INLET PROTECTION
- = CURB CUT PROTECTION
- = INLET PROTECTION
- = CONSTRUCTION ENTRANCE
- = ROCK CHECK DAM
- = EROSION CONTROL BLANKET (ECB)

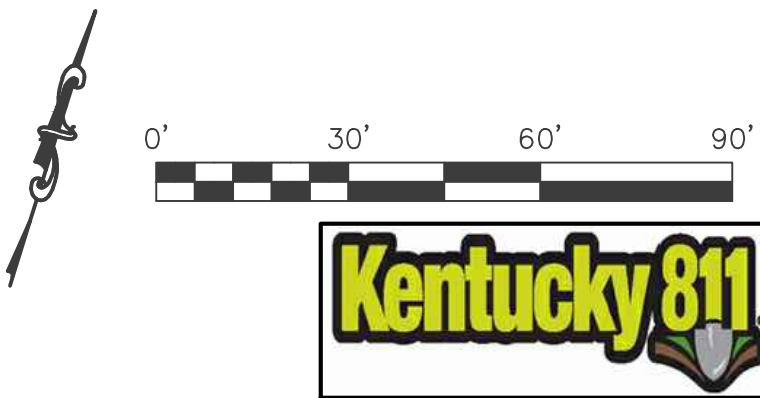

BLEND PAK BLDG EXPANSION
PO BOX 458
BLOOMFIELD, KY 40008

BCD INC.
1962 FILIATREAU LN
BARDSTOWN, KY 40004



LEBANON OFFICE:
335 N. WOODLAWN AVE.
LEBANON, KY 40033

NATHAN ALLAN KING
P.E. #24283 P.L.S. #3831
BUSINESS: (270) 692-0089
MOBILE: (270) 590-4603
Nathan@njkwm.net

REVISIONS:	DATE:

SCALE: 1" = 30' DATE: 01-23-23

SHEET:
EROSION &
SEDIMENT CONTROL

C3.01