

April 21, 2025

Golightly & Long Properties, LLC
5280 Cairo Road
Paducah, KY 42001

BIDDING ADDENDUM 2

For work titled:
Acee's Neighborhood Market & Deli
1000 Holiday Lane
Fulton, KY 42041
Project Number: 23-7038

TO ALL BIDDERS

GENERAL NOTES

This addendum is issued for the purpose of clarifying the intent of the contract documents or for making necessary corrections, deletions, and/or additions to the documents on all items of discrepancy raised up to the time of the issuance of this addendum.

Each bidder is hereby instructed and authorized to incorporate into his proposal the instructions contained in this addendum. This addendum forms a part of the bidding and contract documents and modifies the original bidding documents, dated March 17, 2025 . Acknowledge receipt of this addendum in space provided on Bid Form. FAILURE TO DO SO MAY SUBJECT BIDDER TO DISQUALIFICATION.

This addendum consists of (three) (3) – 8-1/2" x 11" pages including this cover sheet

PROJECT MANUAL

1. 001116	CHANGE Article 1.2.A.1 to reflect the new Bid Date of Wednesday, April 30, 2025 at 2:00pm
2. 001116	E-MAIL OF BIDS bids may be emailed to Nathan Long at nlong@acees.com prior to 2:00pm on Wednesday April 30, 2025; bids should be clearly identified in the subject line of the email as "Fulton, KY Acees – BID PROPOSAL" along with identifying information of the company submitting the bid, the required bid documents must all be scanned into a single PDF file all signatures shall be written prior to scanning the documents, digital signatures are not allowed. Please note the contractor accepts all responsibility for electronic submissions of bids and their timely delivery, late or mis-labeled bids may not be accepted. It is recommended that any emailed submissions are followed up with a phone call to be sure it was received.

DRAWINGS

3. "A" Sheets	CLARIFICATION: Wall coverings in rooms 102 and 103 shall be smooth finish FRP, Sequentia Flat by Crane Composites or approved equal, see attached sketch.
---------------	--

INFORMATION ITEMS & ANSWERS TO QUESTIONS

4.	Layout Work All final layout and elevations will be by the contractor. The owner will provide benchmarks, control points, and rough layout of building corners, storm sewers, light poles, curb-lines (at PI's Radii points & 100' increments), and paving grade control lines. Contractors shall include in their bids an allowance for this work of \$18,000; layout services will be performed by Klingner & Associates P.C. and directly billed to the contractor. Re-staking of items may incur additional costs above and beyond the stated allowance.
5.	Testing Requirements Concrete testing will be by the project engineer and paid for by the owner (slump, air %, compressive strength). All other testing (Density, etc.) shall be coordinated and paid for by the contractor; all testing shall be observed by the project engineer and/or owner's representative. Certified testing reports shall be promptly transmitted to the owner and project engineer.

ATTACHMENTS

Addenda 2 – Wall Coverings for Rooms 102, 103, and 104 (1 page, 8.5x11)

All other terms and conditions of the Project Manual and Drawings shall remain unchanged.

END OF ADDENDUM 2

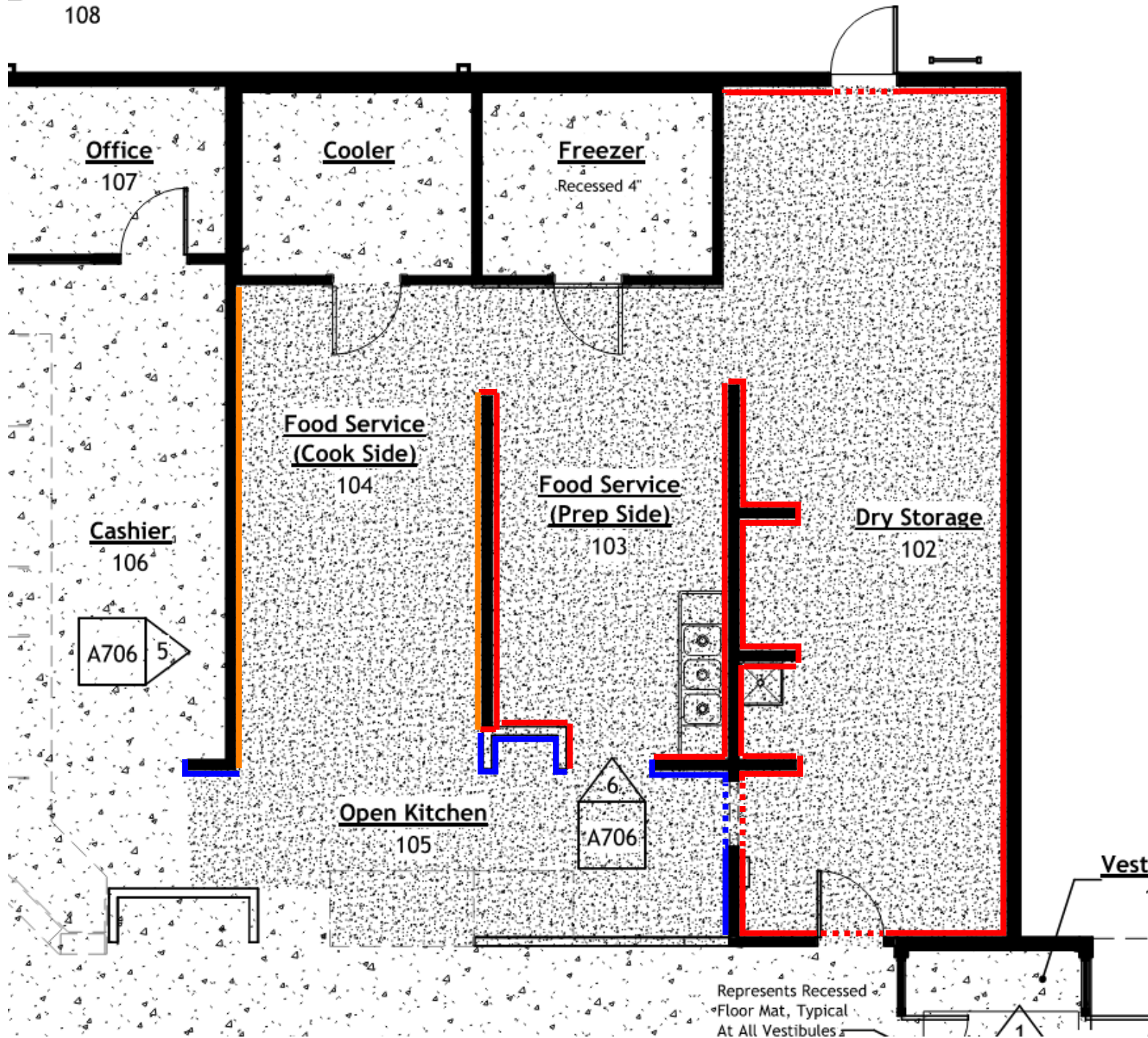

M2	Commercial Grade Stainless Steel Wall Paneling
----	--

FRP1	45" X 48" Symmetrix Smartseam Frp Paneling
	3" X 6" Tile Configuration - Subway Horizontal

FRP2 48x96" SEQUENTIA FLAT - Crane Composites